

Warehouse/ Distribution

8301 Belvedere Avenue
Sacramento, CA 95826

Property Highlights

- + Available SF: ± 115,200 SF
- + ± 1,530 SF Office
- + Column Spacing: ±50' - 60'
- + Clear Height: ±28'
- + Grade-level doors: 2
- + ± 20 trailer parking stalls (or yard area)
- + 53 auto parking stalls
- + Dock Positions: 14
- + Large ±240' truck court/driveway
- + ESFR Sprinklers
- + Strategic Location
 - ±1 mile south of the Howe Avenue/Power Inn Road and HWY 50 interchange

POWER INN SUBMARKET



Contact Us

Ryan DeAngelis, SIOR
Executive Vice President
+1 916 492 6975
ryan.deangelis@cbre.com
Lic. 01280330

Mike Zimmerman, SIOR
Senior Vice President
+1 916 446 8702
mike.zimmerman1@cbre.com
Lic. 01514055

Sean Merold, SIOR
Senior Vice President
+1 916 446 8701
sean.merold@cbre.com
Lic. 01803204

Jimmy Landis
Senior Associate
+1 916 446 8280
jimmy.landis@cbre.com
Lic. 02130311



Warehouse or Distribution

8301 Belvedere Avenue | Sacramento, CA 95826

Site Plan

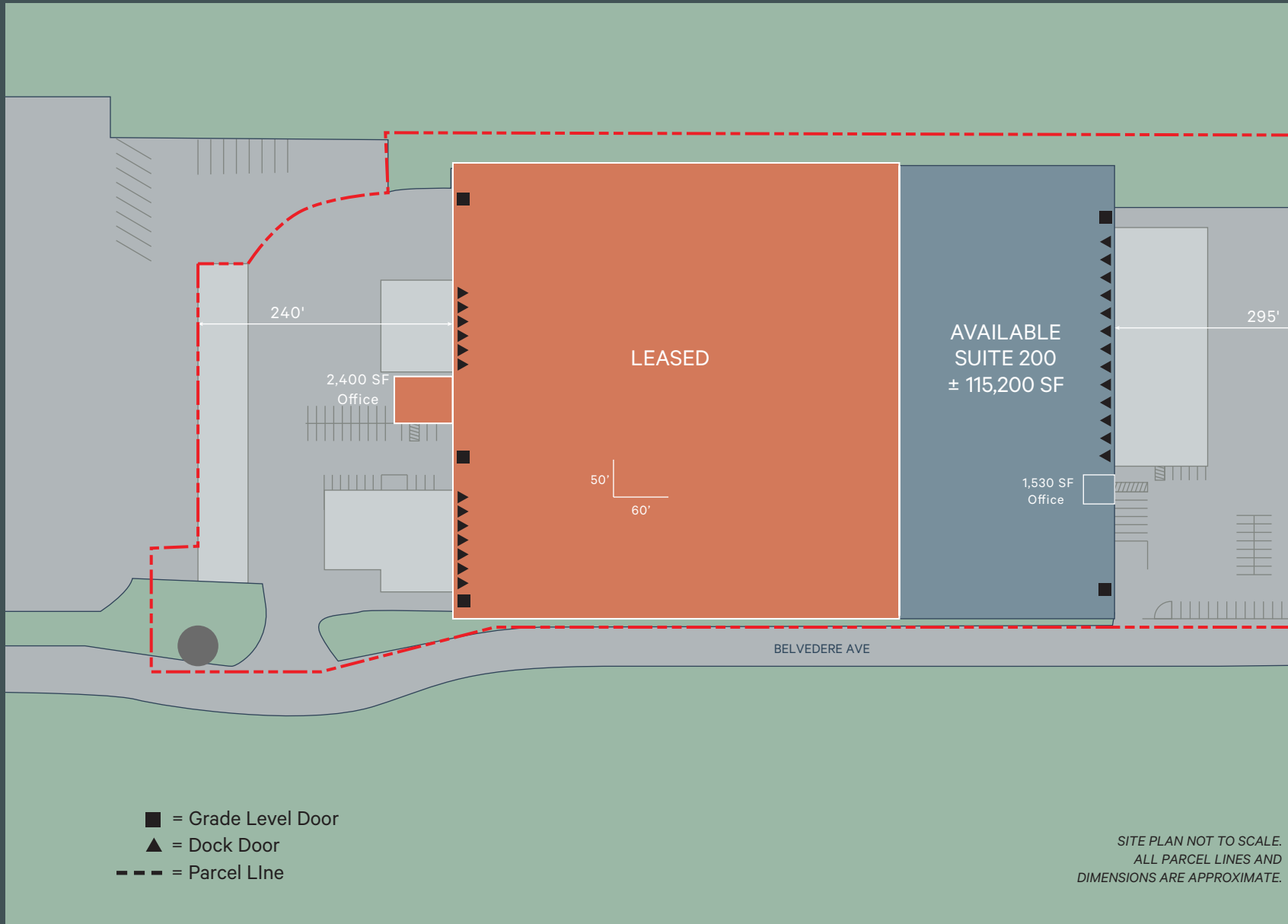

Warehouse or Distribution

8301 Belvedere Avenue | Sacramento, CA 95826

Aerial



Warehouse or Distribution

8301 Belvedere Avenue | Sacramento, CA 95826

For Lease

Strategic Location

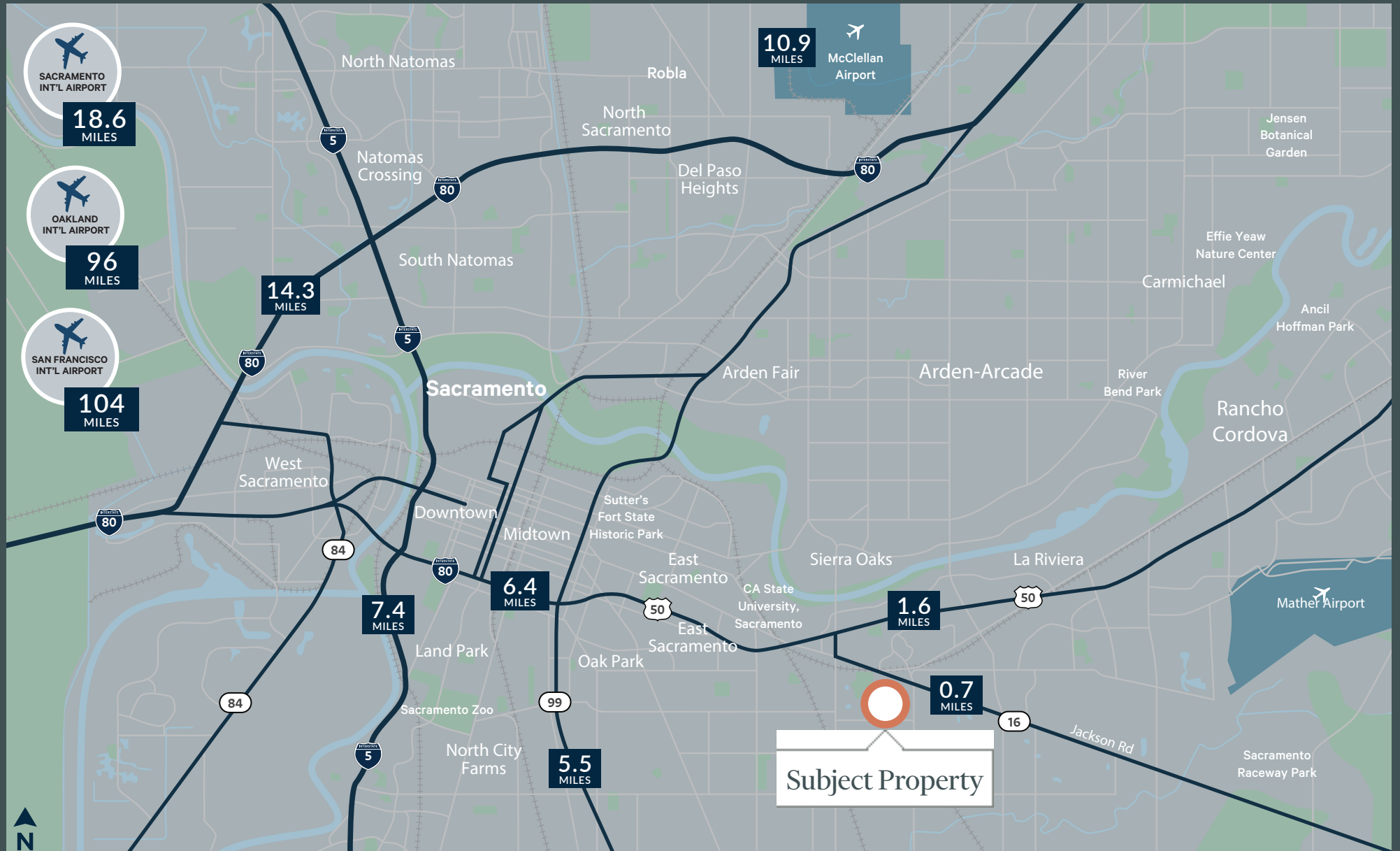

Workforce 2024

WAREHOUSE WORKER LABOR POOL DENSITY (PEOPLE PER SQUARE MILE), 2024



LARGE
WAREHOUSE WORKER
LABOR POOL



LOW
WORKING AGE
PARTICIPATION RATE



LARGE
GROUP OF PART-TIME
COLLEGE STUDENTS FOR
SEASONAL EMPLOYMENT



\$19.18
PER HOUR STARTING WAGE:
FORKLIFT OPERATOR



\$17.02
PER HOUR STARTING WAGE:
FULFILLMENT SPECIALIST

WAREHOUSE WORKER LABOR POOL DENSITY (PEOPLE PER SQUARE MILE), 2024

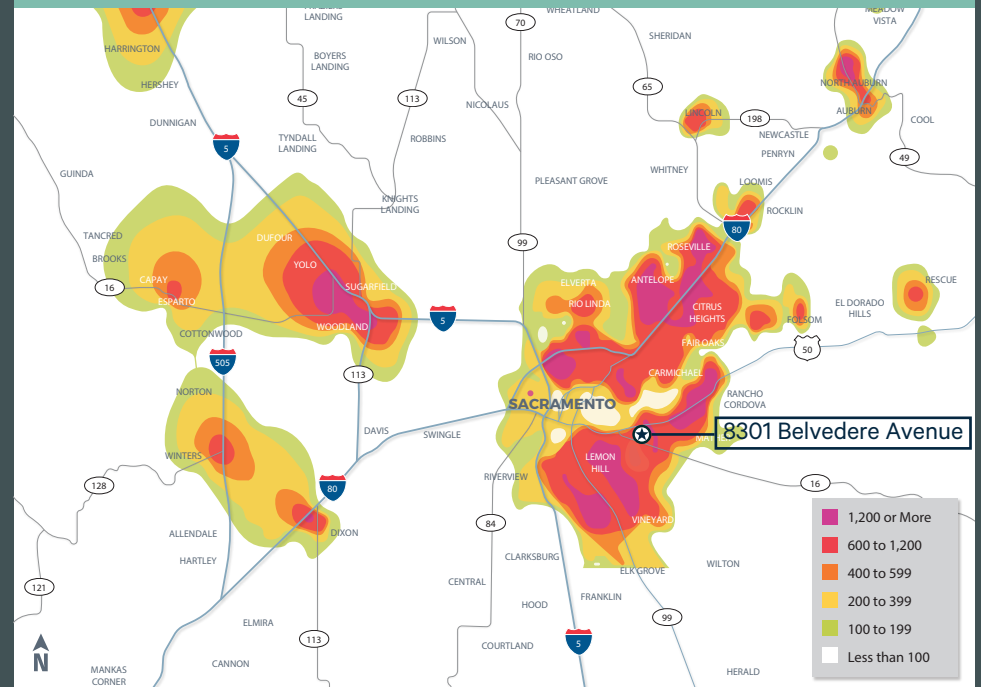

Warehouse/Distribution

8301 Belvedere Avenue | Sacramento, CA 95826

CONTACT US:

Ryan DeAngelis, SIOR

Executive Vice President
+1 916 492 6975
ryan.deangelis@cbre.com
Lic. 01280330

Mike Zimmerman, SIOR

Senior Vice President
+1 916 446 8702
mike.zimmerman1@cbre.com
Lic. 01514055

Sean Merold, SIOR

Senior Vice President
+1 916 446 8701
sean.merold@cbre.com
Lic. 01803204

Jimmy Landis

Senior Associate
+1 916 446 8280
jimmy.landis@cbre.com
Lic. 02130311

© 2024 CBRE, Inc. All rights reserved. This information has been obtained from sources believed reliable, but has not been verified for accuracy or completeness. You should conduct a careful, independent investigation of the property and verify all information. Any reliance on this information is solely at your own risk. CBRE and the CBRE logo are service marks of CBRE, Inc. All other marks displayed on this document are the property of their respective owners, and the use of such logos does not imply any affiliation with or endorsement of CBRE. Photos herein are the property of their respective owners. Use of these images without the express written consent of the owner is prohibited.