

# For lease

12731 Los Nietos Road  
Santa Fe Springs, CA 90670

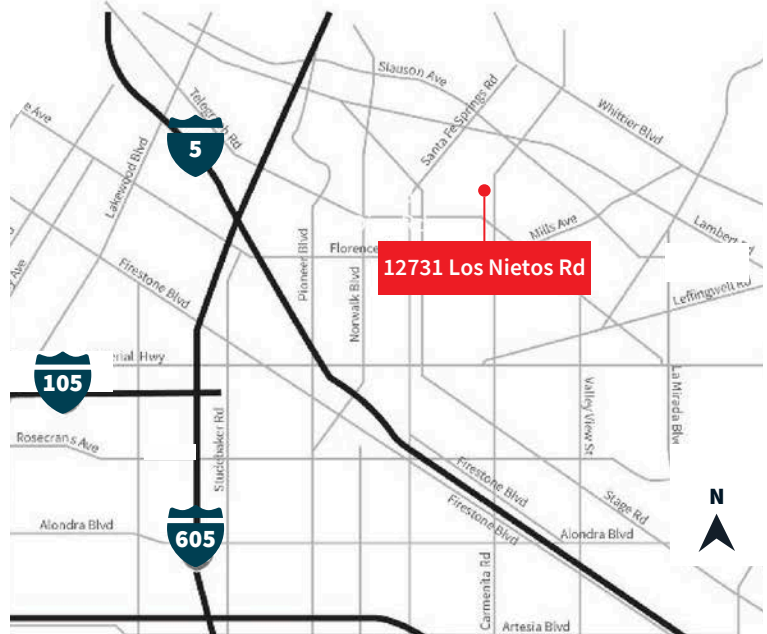

<b>Property size</b>	1.02 acres
<b>Office size</b>	± 1,282 s.f.
<b>Yard</b>	Fenced & paved storage yard
<b>Covered Storage</b>	± 4,000 s.f. with power and lighting
<b>Zoning</b>	M2 Industrial Zoning
<b>Power</b>	400 amps, 120/240 volts (verify)
<b>Asking rate</b>	TBD Opex = \$0.07 psf



# Property Site Plan

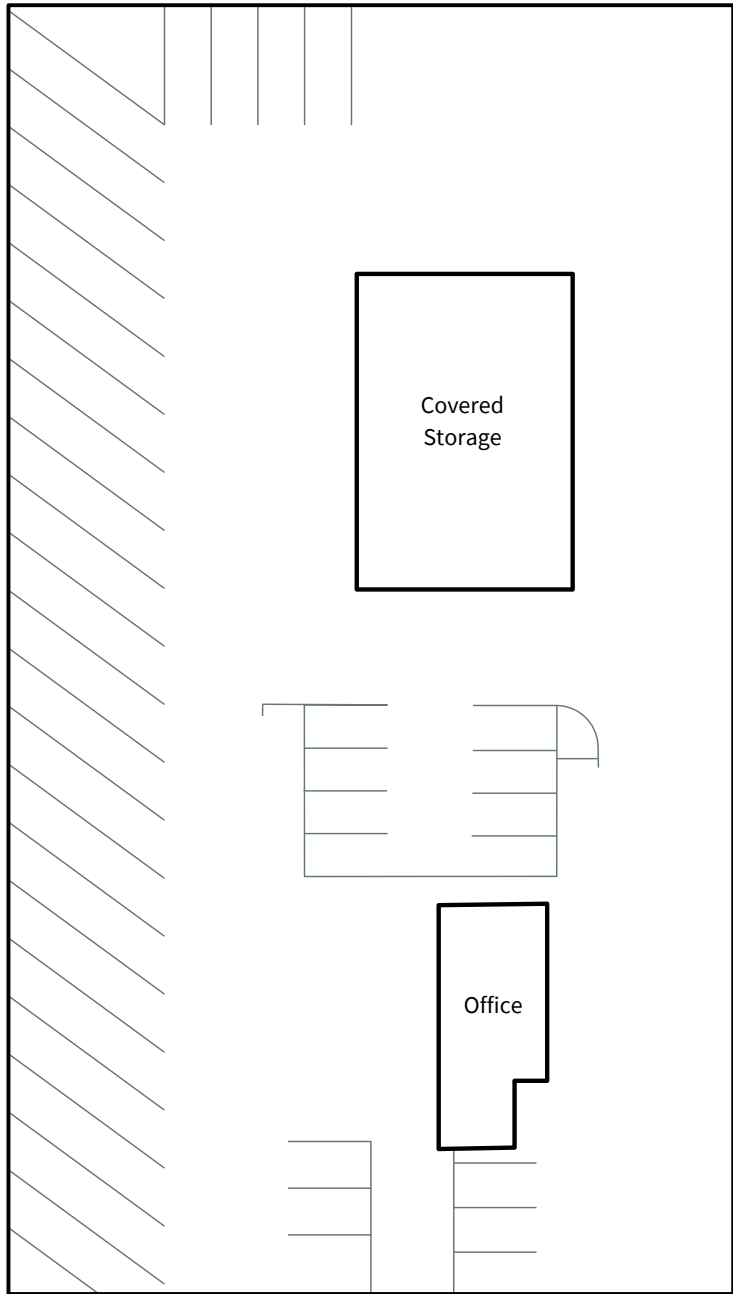

Although information has been obtained from sources deemed reliable, neither Owner nor JLL makes any guarantees, warranties or representations, express or implied, as to the completeness or accuracy as to the information contained herein. Any projections, opinions, assumptions or estimates used are for example only. There may be differences between projected and actual results, and those differences may be material. The Property may be withdrawn without notice. Neither Owner nor JLL accepts any liability for any loss or damage suffered by any party resulting from reliance on this information. If the recipient of this information has signed a confidentiality agreement regarding this matter, this information is subject to the terms of that agreement. © 2024 Jones Lang LaSalle IP, Inc. All rights reserved.

**Luke McDaniel**  
luke.mcdaniel@jll.com  
(949) 885-2974  
Lic. #01203625

**Cameron Driscoll**  
cameron.driscoll@jll.com  
(949) 885-2976  
Lic. #01224141

**Ashley Ramirez**  
ashley.ramirez@jll.com  
(949) 885-2913  
Lic. #02106273

**Erin McCloskey**  
erin.mccloskey@jll.com  
(949) 930-7891  
Lic. #02244405